

THE HANBURY | THREE BEDROOM HOUSE



All photos, images and computer generated images in these particulars are for illustrative purposes and general guidance only. They do not constitute a contract, part of contract or warranty. External finishes, street configuration and landscaping may vary from plot to plot. Please check with OVH's sales advisor for further details relating to specific plots. Measurements provided are estimated; to ensure accuracy please undertake your own measurements before ordering any flooring, fixtures, fittings or furniture.

About the house

The Hanbury is a lovely three bedroom family home. On the ground floor there is an open plan kitchen/ diner with French doors leading into the rear garden a spacious living room and a handy cloakroom. Upstairs there is a master bedroom with en-suite, two further bedrooms and a family bathroom.

Features

- Available through shared ownership with freehold transferred once 100% is owned
- 3 bedroom semi-detached house (approx. 761 SQFT)
- Stylish kitchen with integrated oven/hob/ extractor, fridge freezer and dishwasher
- Vinyl floorcovering to kitchen, bathrooms and cloakroom
- Private rear garden
- Off road parking

THE HANBURY | FLOOR PLANS

Ground floor

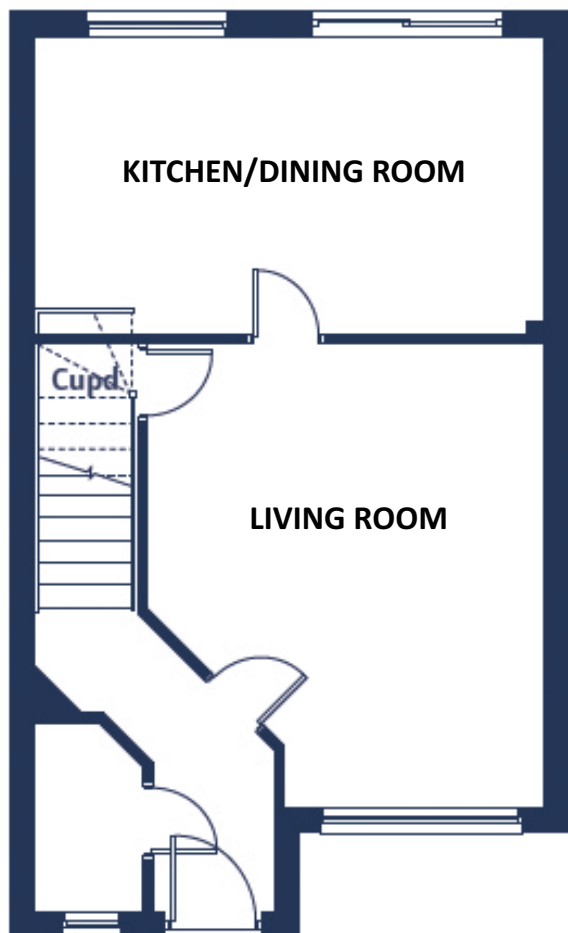

First floor

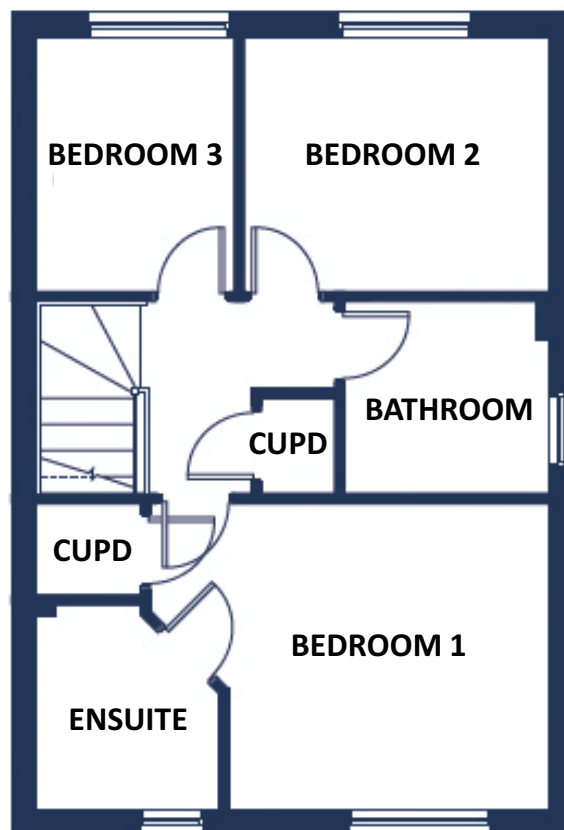

Room sizes

Lounge: 14.3" x 12.1"

Kitchen/dining: 15.4" x 8.10"

Bedroom 1: 12" x 9.6"

Bedroom 2: 9.3" x 7.7"

Bedroom 3: 7.7" x 5.10"

All photos, images and computer-generated images in these particulars are for illustrative purposes and general guidance only. They do not constitute a contract, part of contract or warranty. External finishes, street configuration and landscaping may vary from plot to plot. Please check with OVH's Sales Negotiator for further details relating to specific plots. The appliances/white goods provided are a cooker, hob and extractor hood – any other appliances indicated on these plans are to indicate space available. Measurements provided are estimated; to ensure accuracy please undertake your own measurements before ordering any flooring, fixtures, fittings or furniture.

Note: Bedroom dimensions taken into wardrobe recess. All wardrobes are subject to site specification. Please see Sales Negotiator for further details.