



CRANBERRY GARDENS CHESHIRE



One Vision Housing are delighted to launch a collection of new homes for Shared Ownership within the exclusive Redrow Cranberry Gardens development in Congleton, Cheshire.

Cranberry Gardens is located just to the north of the town, within easy reach of both primary and secondary schools, just a short bus ride from the station, giving connections to Manchester in just 40 minutes.

Our homes include two and three bedroom houses so are perfect for a range of home buyers including first time buyers, growing families looking for more space and households looking to downsize to a modern, easy to manage new home.

With Shared Ownership you are only required to secure a smaller mortgage, resulting in a reduced deposit too, so you may be able to buy your dream home sooner than you think!

Our next phase of homes will be available soon. Register your interest today and we'll be in touch to help you buy your new home.



Register your interest today:

0333 733 8888
sales@ovh.org.uk

THE AVON | TWO BEDROOM HOUSE



About the house

The Avon is a two bedroom home ideal for first time buyers or households looking to downsize to a smaller, easy to manage new build home. The entrance hall leads to a well-planned kitchen at the front of the home and an open plan living room/dining room to the rear with access to the garden. The ground floor is completed with a handy cloakroom. Two double bedrooms and a family bathroom can be found on the first floor.

Features

- New build house
- Available through Shared Ownership
- Open plan living / dining room
- Two bedrooms
- Downstairs cloakroom
- Modern Kitchen
- Parking

THE AVON | FLOOR PLANS

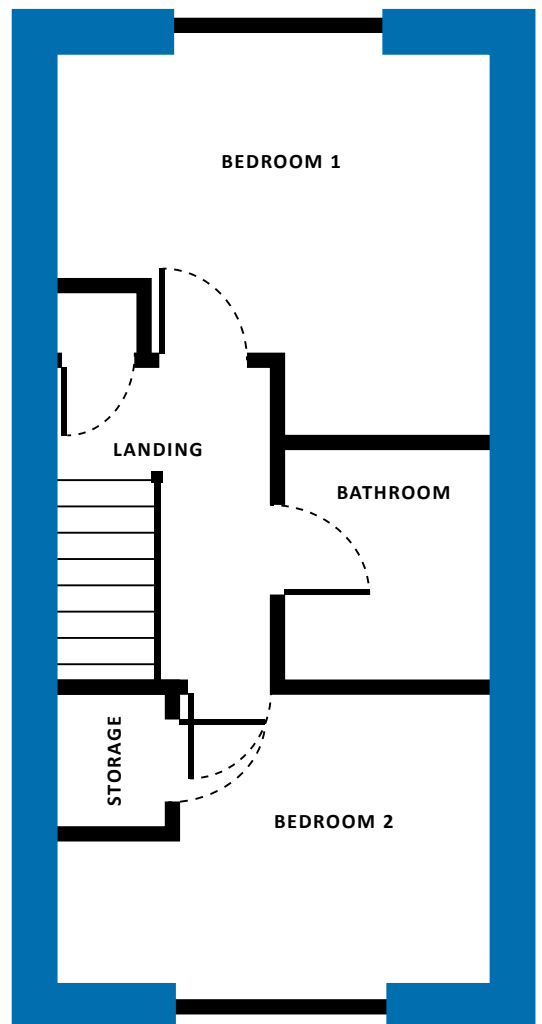
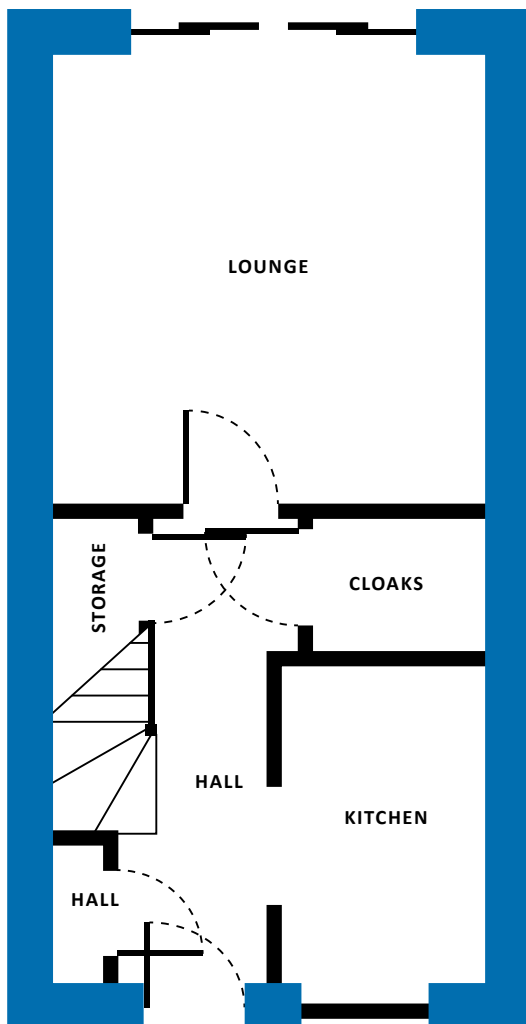

Room sizes

Lounge: 3.91m x 3.90m

Kitchen: 1.91m x 2.80m

Bedroom 1: 3.91m x 3.37m

Bedroom 2: 3.91m x 2.51m

Bedroom 3: 1.7m x 2m

Bathroom: 1.7m x 2m

All photos, images and computer-generated images in these particulars are for illustrative purposes and general guidance only. They do not constitute a contract, part of contract or warranty. External finishes, street configuration and landscaping may vary from plot to plot. Please check with OVH's Sales Negotiator for further details relating to specific plots. The appliances/white goods provided are a cooker, hob and extractor hood – any other appliances indicated on these plans are to indicate space available. Measurements provided are estimated; to ensure accuracy please undertake your own measurements before ordering any flooring, fixtures, fittings or furniture.

Note: Bedroom dimensions taken into wardrobe recess. All wardrobes are subject to site specification. Please see Sales Negotiator for further details.

THE AVON 3 | THREE BEDROOM HOUSE



About the house

The Avon 3 is a three bedroom home which will appeal to a range households including those looking for more space for a growing family or those looking to downsize to a smaller, easy to manage new build home. The entrance hall leads to a well-planned kitchen at the front of the home and an open plan living room/dining room to the rear with access to the garden. The ground floor is completed with a handy cloakroom. On the first floor there are two double bedrooms, a single bedroom and a family bathroom.

Features

- New build house
- Available through Shared Ownership
- Open plan living / dining room
- Three bedrooms
- Downstairs cloakroom
- Modern Kitchen
- Parking

THE AVON 3 | FLOOR PLANS

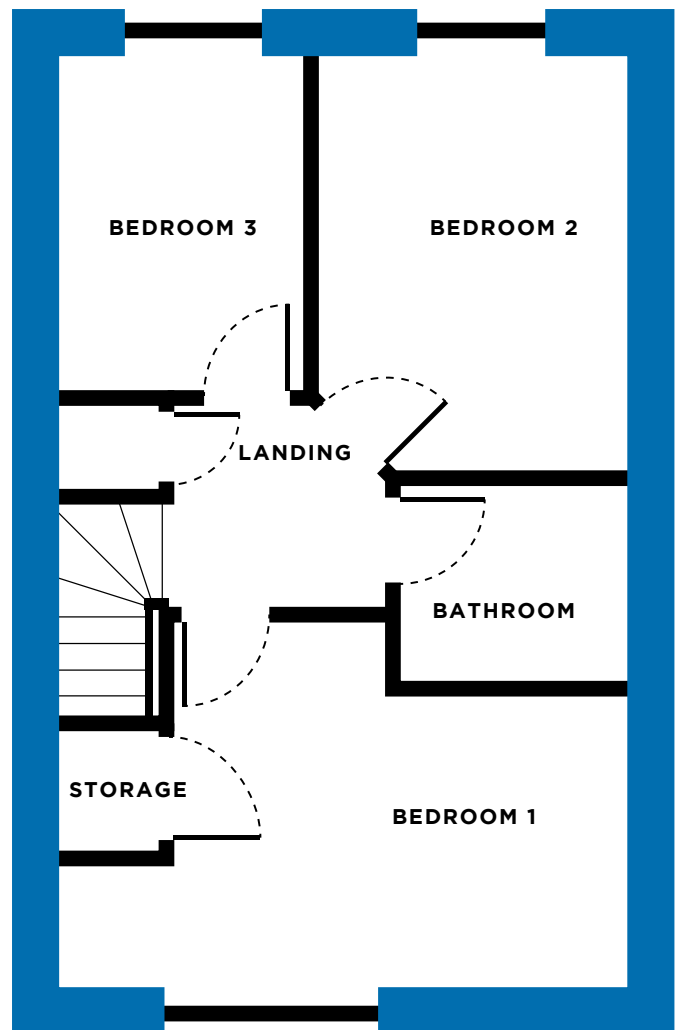
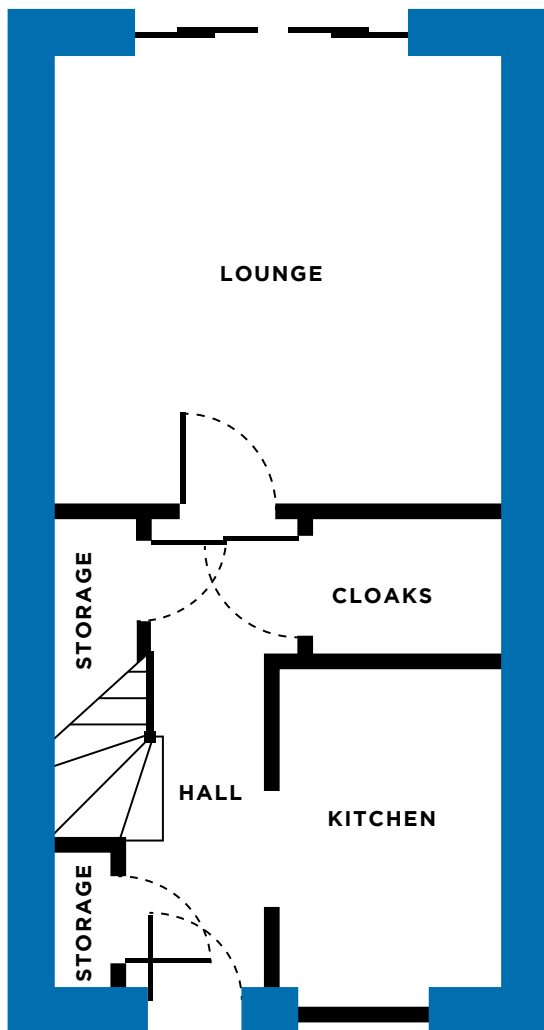

Room sizes

Lounge: 3.91m x 3.90m

Kitchen: 1.91m x 2.80m

Bedroom 1: 5.10m x 3.19m

Bedroom 2: 2.78m x 2.94m

Bedroom 3: 2.24m x 2.92m

Bathroom: 2.06m x 1.70m

All photos, images and computer-generated images in these particulars are for illustrative purposes and general guidance only. They do not constitute a contract, part of contract or warranty. External finishes, street configuration and landscaping may vary from plot to plot. Please check with OVH's Sales Negotiator for further details relating to specific plots. The appliances/white goods provided are a cooker, hob and extractor hood – any other appliances indicated on these plans are to indicate space available. Measurements provided are estimated; to ensure accuracy please undertake your own measurements before ordering any flooring, fixtures, fittings or furniture.

Note: Bedroom dimensions taken into wardrobe recess. All wardrobes are subject to site specification. Please see Sales Negotiator for further details.