

HAWTHORN GROVE, APPLETON THORN

New Build Homes for Shared Ownership

One Vision Housing are delighted to launch just 11 new homes for Shared Ownership within the exclusive Bloor 'Hawthorn Grove' development, close to the popular village of Appleton Thorn, within easy reach of schools and access to the M56 and M6 motorways.

Our homes include two and three bedroom semi-detached and mews houses so are perfect for a range of home buyers including first time buyers, growing families looking for more space and households looking to downsize to a modern, easy to manage new home.

This is a fantastic location and we expect demand to be high so register your interest today.

0333 733 8888
sales@ovh.org.uk

Our first homes will be available from Autumn 2019 and with Shared Ownership you need a lower deposit and mortgage so you may be able to buy your dream home sooner than you think!



Available Homes	House Type	Open Market Value	30% Share Value	Rent Payable PCM	50% Share Value	Rent Payable PCM	75% Share Value	Rent Payable PCM	Service Charge
Plot 21 & 22	The Sinclair 2 Bedroom House	£205,000	£61,500	£328.85	£102,500	£234.90	£153,750	£117.45	TBC
Plot 53 & 54	The Sorley 3 Bedroom House	£242,000	£72,600	£388.21	£121,000	£277.29	£181,500	£138.65	TBC

Prices based on current market value.

Share and rent options are for illustrative purposes only. Shares available from a minimum of 30% to a maximum of 75% initially. Further shares can be purchased up to 100%. Actual share purchased will depend on individual circumstances. Shared Ownership available to qualifying purchasers. Your home may be repossessed if you do not keep up mortgage or rent payments.

THE SINCLAIR | TWO BEDROOM HOUSE



This two bedroom home is ideal for first time buyers or households looking to downsize to a smaller, easy to manage new build home. The entrance hall leads to a spacious living room with an open plan kitchen / dining room to the rear of the home, with access to the garden. The ground floor is completed with a handy cloakroom. Two double bedrooms and a family bathroom can be found on the first floor.

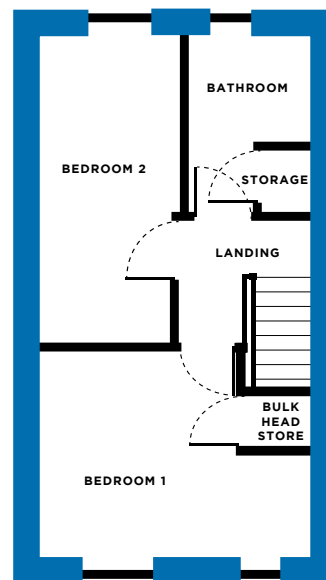
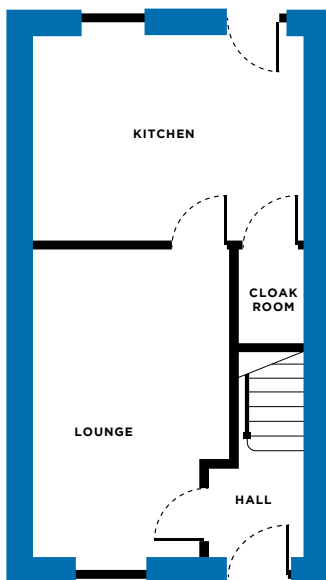

Key Features

- New build two bed home
- Available to buy through Shared Ownership
- Open plan kitchen / dining room
- Integrated kitchen appliances
- Downstairs cloakroom
- Family bathroom
- Two double bedrooms

All photos, images and computer generated images in these particulars are for illustrative purposes and general guidance only. They do not constitute a contract, part of contract or warranty. External finishes, street configuration and landscaping may vary from plot to plot. Please check with OVH's sales advisor for further details relating to specific plots. Measurements provided are estimated; to ensure accuracy please undertake your own measurements before ordering any flooring, fixtures, fittings or furniture.

THE SORLEY | THREE BEDROOM HOUSE



This three bedroom home will appeal to a range of households including those looking for more space for a growing family or those looking to downsize to a smaller, easy to manage new build home. The entrance hall leads to a spacious living room with an open plan kitchen / dining room to the rear of the home, with access to the garden. The ground floor is completed with a handy cloakroom. On the first floor there are two double bedrooms, a single bedroom and a family bathroom.

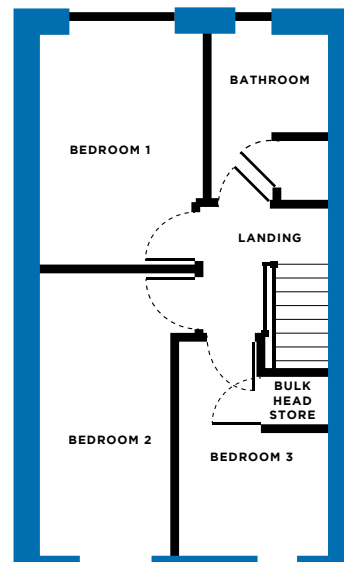
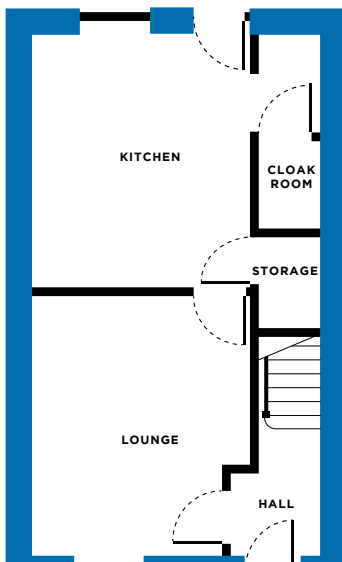

Key Features

- New build three bed home
- Available to buy through Shared Ownership
- Open plan kitchen / dining room
- Integrated kitchen appliances
- Downstairs cloakroom
- Modern family bathroom
- Two double and a single bedroom